



Legend

-  Denotes Soil Boring Location and Number
-  Denotes Test Pit Location and Number

Notes

1. Borings were drilled by Soil Essentials on September 26 and 27, 2022.
2. Test pits were excavated by Hellenbrand Brothers Excavating and logged by CGC on August 5, 2022.
3. Boring and test pit locations are approximate.
4. Base map was prepared by Knothe & Bruce Architects.

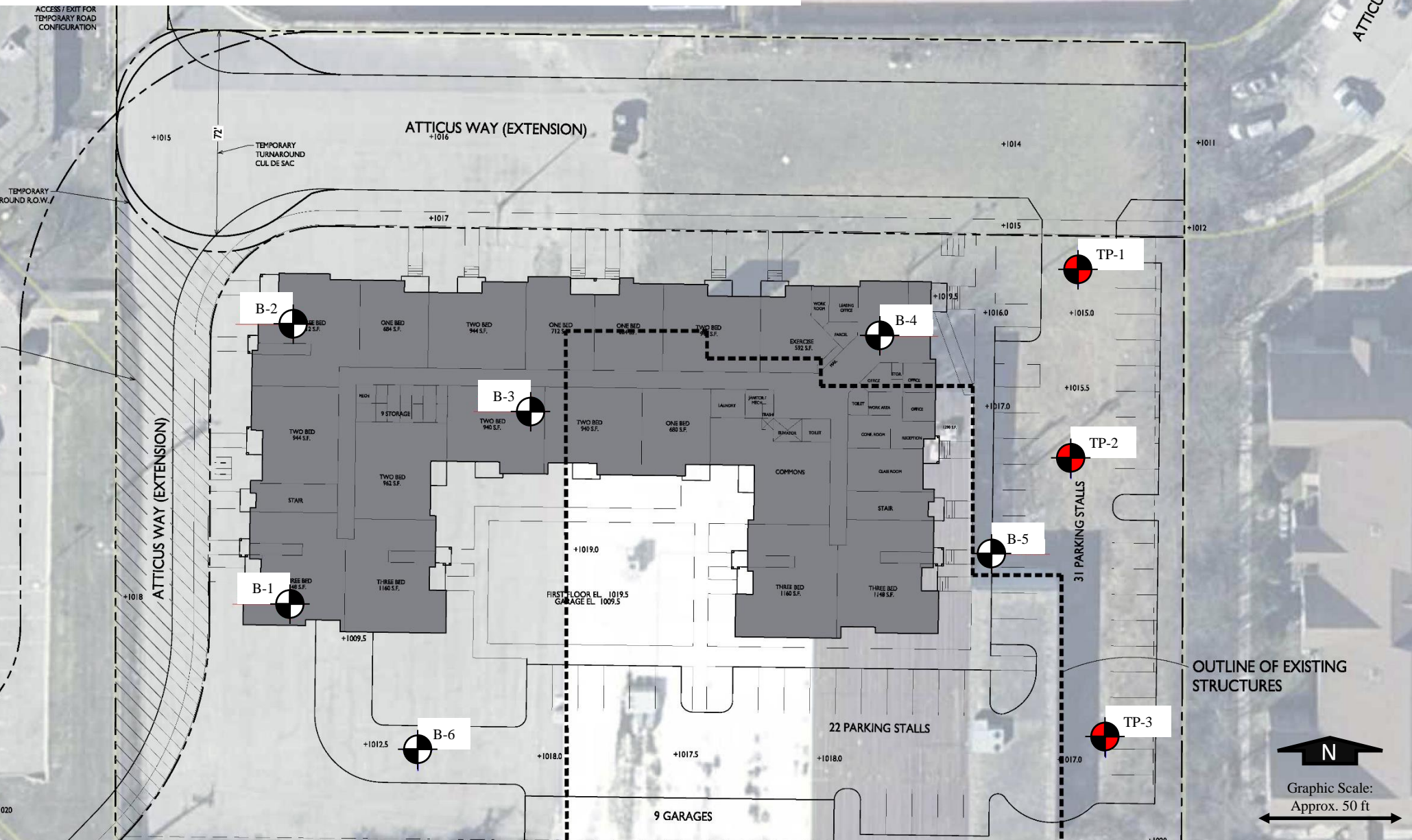

Job No.:
C22358

Date:
10/2022

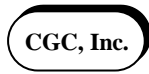

SOIL BORING & TEST PIT LOCATION EXHIBIT
Proposed Summit Ridge Apartments
 4649 Verona Road
 Madison, Wisconsin





LOG OF TEST BORING

Project Summit Ridge Apartments
4649 Verona Road
 Location Madison, WI

Boring No. B-1
 Surface Elevation (ft) 1020.0±
 Job No. C22358
 Sheet 1 of 1

2921 Perry Street, Madison, WI 53713 (608) 288-4100, FAX (608) 288-7887

SAMPLE					VISUAL CLASSIFICATION and Remarks	SOIL PROPERTIES				
No.	Rec (in.)	Moist	N	Depth (ft)		qu (qa) (tsf)	W	LL	PL	LI
					X	2.5 in. Asphalt Pavement/9 in. Base Coarse				
1	16	M	6							
2	10	M	5							
3	9	M	20							
4	16	M	7							
5	15	M	9							
6	16	M	13							
7	15	M	15							
8	17	M	14							
				30		End of Boring at 30 ft				
						Backfilled with Bentonite Chips and Asphalt Patch				

WATER LEVEL OBSERVATIONS				GENERAL NOTES				
While Drilling	∇	NW	Upon Completion of Drilling	NW	Start	9/27/22	End	9/27/22
Time After Drilling					Driller	SE	Chief	CRJ
Depth to Water					Logger	Armando	Editor	ELC
Depth to Cave in				26.2'	Drill Method	2.25" HSA; Autohammer		
The stratification lines represent the approximate boundary between soil types and the transition may be gradual.								



LOG OF TEST BORING

Project Summit Ridge Apartments
4649 Verona Road
 Location Madison, WI

Boring No. B-2
 Surface Elevation (ft) 1018.5±
 Job No. C22358
 Sheet 1 of 1

2921 Perry Street, Madison, WI 53713 (608) 288-4100, FAX (608) 288-7887

SAMPLE					VISUAL CLASSIFICATION and Remarks	SOIL PROPERTIES				
No.	Rec (in.)	Moist	N	Depth (ft)		qu (qa) (tsf)	W	LL	PL	LI
					X	2 in. Asphalt Pavement/8 in. Base Coarse				
1	15	M	3		█	FILL: Stiff, Brown Sandy Lean Clay, Scattered Gravel (1.5-1.75)				
2	16	M	6		█	Stiff, Brown Lean CLAY, Trace Sand, Scattered Gravel (CL) (1.75-2.0)				
3	16	M	10	5	█	(1.0-1.5) 22.4				
4	17	M	8	10	█	Loose to Medium Dense, Brown SILT, Trace Sand and Gravel (ML) 21.7				
5	15	M	11	15	█	Medium Dense, Brown Fine SAND, Trace Silt, Scattered Silt Seams, Trace Gravel (SP)				
6	16	M	18	20	█					
7	16	M	16	25	█					
8	15	M	16	30	█					
End of Boring at 30 ft										
Backfilled with Bentonite Chips and Asphalt Patch										

WATER LEVEL OBSERVATIONS				GENERAL NOTES				
While Drilling	∇	NW	Upon Completion of Drilling	NW	Start	9/26/22	End	9/26/22
Time After Drilling					Driller	SE	Chief	CRJ Rig Geoprobe
Depth to Water				∇	Logger	Armando	Editor	ELC 7822DT
Depth to Cave in					Drill Method	2.25" HSA; Autohammer		
The stratification lines represent the approximate boundary between soil types and the transition may be gradual.								